

Robert A. Kerns  
in right of  
James Slayman

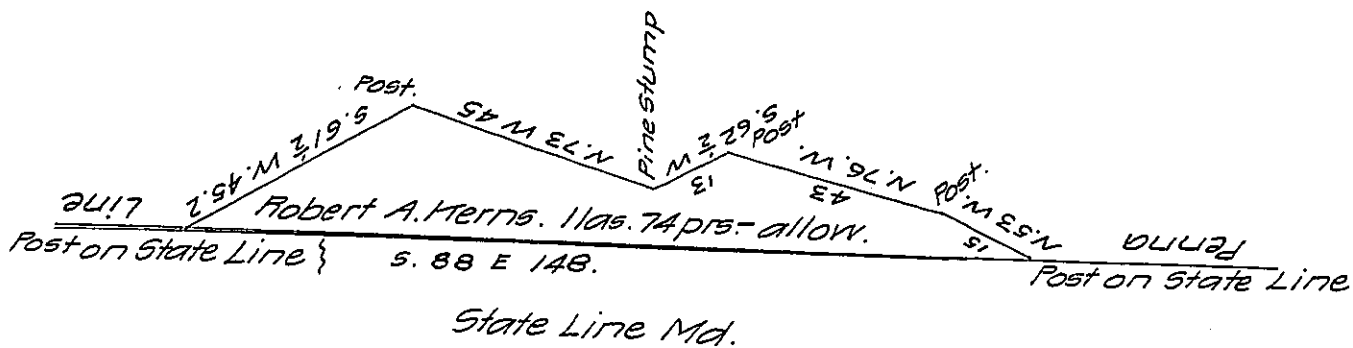

A draft of a tract of land situated in Bethel Township, Fulton County, Penna. containing eleven acres and seventy four perches and allowances of 6 per cent for roads &c. Surveyed for Robert A. Kerns the twenty second day of January A.D. 1866. In pursuance of a warrant granted to the said Robert A. Kerns bearing date the 1st day of January A.D. 1866.

Wm. P. Gordon Co. Sv.

To Jacob M. Campbell, Sv. Gnl.

N.B. Sved by Geo. Holly, Esq. the 22d day of Jan. 1866 and approved by me this 4th of Dec. 1866.

Wm. P. Gordon Co. Sv.

IN TESTIMONY that the above is a copy of the original remaining on file in the Department of Internal Affairs of Pennsylvania, made conformably to an Act of Assembly approved the 16th day of February, 1833, I have hereunto set my Hand and caused the Seal of said Department to be affixed at Harrisburg, this eleventh day of November 1907

Henry Houck  
Secretary of Internal Affairs.